

## STERN S200

### Stabilimento / Plant

Via Bicocca, 14/C - 40026 Imola (BO) - Italy  
Tel. +39 0542 653441 - Fax +39 0542 653601  
[www.sternweber.com](http://www.sternweber.com)  
e-mail: [sternweber@sternweber.com](mailto:sternweber@sternweber.com)

Sede Legale ed Amministrativa / Head Quarter  
CEFLA s.c. - Via Selice Prov.le, 23/a  
40026 Imola (BO) - Italy  
Tel. +39 0542 653111 - Fax +39 0542 653344



Essential comfort





## STERN S200 CONTINENTAL

### Fluidity and flexibility

With the S200 Continental the dentist's work patterns are immediately rendered more fluid. Its pure, practical design smoothly adapts to the operating style of those who work with reflex-arm instruments. Dental unit and patient chair have been designed to ensure the dentist works comfortably in all positions in the 9-to-2 o'clock range, stress-free and with maximum patient comfort. With the S200 working at your very best couldn't be easier – as you'll always have a partner you can count on. S200: guaranteed comfort, performance and practicality.



## STERN S200 INTERNATIONAL

### Versatility and convenience

Stern Weber puts your operating methods first because they are the indispensable starting point for providing you with easy access to every single instrument and control. The S200 International, hanging tubes version, provides versatility and convenience. Suspended on balanced arms the dentist's module can be guided smoothly and effortlessly. The instruments are always within arm's reach – whatever the dentist's preferred working position. The staggered instrument layout on the dentist's module takes work priorities into account and facilitates smooth handpiece pick-up.



MAXIMUM PRACTICALITY



The X-ray viewer is installed on the dentist's module for convenient viewing of intra-oral X-rays. A panoramic X-ray viewer is available as an option.



The instrument tubing on the dentist's and assistant's modules can easily be replaced via rapid couplings.



To ensure proper cleaning and sanitising the instrument holder can be removed.



User-friendly controls, a LED bar that immediately shows instrument-relative data, an Xray viewer incorporated on the dentist's control panel, easy-to-use main function keys.

The LED bar indicates the set speed of the turbine and micromotor as well as scaler power.



**Short Arm**  
A version with a fixed, shorter arm that makes the dental unit even more compact is available on request.



Slim and essential, the dentist's module on the Continental version is designed to give rapid access to instrument tubing connections.

Instrument tubing combines good travel with balance. The end-of-stroke lock system makes the instrument light and manageable.



Smooth teamwork

Simplicity is a concept that smoothes dentist-assistant teamwork enormously. The S200 brings all the essential elements together in a compact space that lets the dental team work easily and efficiently. Where two-handed tasks are required the dentist will find everything within arm's reach, rationally distributed around the focal point, the patient's mouth.

# TOUGH AND RELIABLE



Upholstery is made of tough yet flexible co-moulded polyurethane lined with seamless SKAI stretch fabric that is heat-welded to the upholstery.

Those parts of the patient chair most subject to wear are made of solid shock-absorbent, scratchproof polyurethane.



The ceramic cuspidor bowl has no gaps: this eliminates any pockets of bacterial contamination and any collection/stagnation of fluids.

Rotation through 160° increases the space available to the assistant and makes the bowl easier for the patient to use.



The stainless steel tray-holder module is removable and can be sterilised in an autoclave.

On-support rotation and on-guide slide shift, located directly underneath the dentist's module, give exceptional versatility.



The suction tube duct is provided with an easily accessible filter. The large surface area of the filter reduces the need for frequent drainage.



Nylon is the perfect material for parts subject to stresses and strains and provides extremely long-lasting resistance: that's why it is used on the instrument reflex arms on the Continental version.

## Top quality materials

Careful selection of materials according to their specific use ensures longer-lasting performance. A hard-wearing structure is essential, hence Stern Weber's commitment to sturdiness. Thanks to the employment of specially chosen materials and careful quality controls on every single component, Stern Weber provides the dentist with a tool that is as strong as it is reliable. Aluminium alloys improve mechanical characteristics and give the structural parts of the unit and patient chair greater rigidity and strength.



# COMPLETE COMFORT



### Curing Light

An exclusive, patented instrument with programmes and accessories to meet every possible need. Light and articulated, it can be swivelled up to 180° for use in pen and gun-type mode.

Very high efficiency LEDs, 6 time/power programs, energy delivered (max. 36,000 mJ) and compact design make the T-LED an ideal compound curing tool.



### 6 programmes to meet every possible need

The new light emission cycles have, following in-depth analysis and clinical recommendations, been optimised to deliver the right amount of energy in relation to minimum light exposure times. This prevents compound shrinkage.



### Atlaxis headrest

The Atlaxis 3 (optional) headrest allows natural positioning of the patient's head.

A pneumatic device makes it possible to shift, adapt and fix the upholstery in the ideal position, effortlessly and without having to act on levers or brakes.

### Universal headrest

Double-articulating headrest with mechanical lock device.

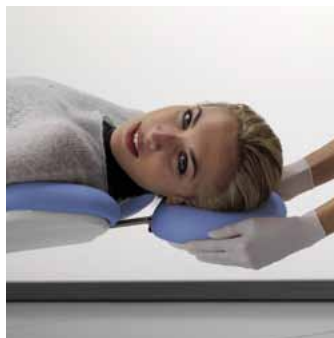
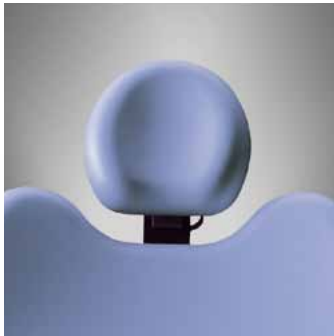
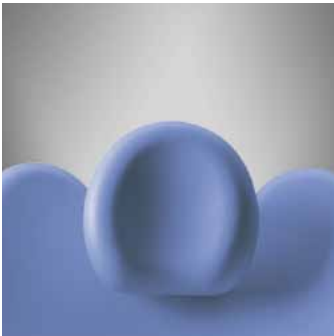

### Anatomic patient chair

A relaxed patient, who helps the dentist carry out treatment and obtain the best possible results, is always a plus. With its wrap-around anatomic shaping, the patient chair provides excellent support even with patients of slight build. Smoothly coordinated patient chair movement ensures correct alignment of the lower limbs; the patient's shoulders are constantly supported to prevent tension in the neck and the shoulders themselves. Recall to the Trendelenburg position is automated.



### Memory-Foam upholstery (\*)

Anatomical Memory-Foam upholstery ensures proper patient support and greater comfort, especially during long operations. Optimal distribution of the surface area in contact with the patient's body and uniform exertion of pressure make the patient more comfortable and relaxed.

(\*) optional

## Ever-present ergonomics

From patient chair to dental unit, from dentist to patient, ergonomics is a key element in the establishment of optimal working conditions and maximum comfort for everyone. Ever-more attentive to ergonomic design, Stern Weber provides a patient chair with outstanding anatomic shaping, smooth movement and a headrest that is seen as the industry benchmark.

# THE IMPORTANCE OF POSTURE



The seat backrest supports the lumbar region, following the slight movements of the chest through a spring operated compensation system.

The sole function of the backrest is to provide proper lumbar support; its compact design prevents contact perspiration.



Lumbar support on the new stool can be adjusted both horizontally and vertically. Adjustment of seat height (470 – 630 mm) ensures optimal posture for dentists 1.56 m – 1.96 m tall; an extension kit is also available to accommodate dentists as tall as 2.06 m (570 – 730 mm).



Seat tilt adjustment and front zone flexibility ensure there is no pressure on the thigh underside zone.



## Simple, practical controls

The new stool is easy to adjust. Correct positioning of the horizontal-slide adjustment levers can be done by wrist contact alone; since use of fingers is not required, both good hygiene and user-friendliness are assured.



**Foot control**  
The multi-function foot control is available in three versions: horizontal-slide lever control, conventional pressure-operated foot control and the all-new Power Pedal.



All basic services and controls can be activated via the foot control, thus improving hygiene, saving time and bringing the focus back to the patient.



When the video camera is extracted the foot control can also be used for the freeze-frame function.

## Feeling good, working better

Working comfort has many influencing factors. Ergonomic instruments reduce hand fatigue, yet ergonomically designed control devices such as the foot control also make a crucial contribution to operating comfort. In particular, the new ergonomic stool helps establish a healthy posture and protects dentists against discomfort and the development of musculoskeletal problems. T9 belongs to a new generation of stools: the result of close attention to essential ergonomics, they provide the dentist with the reassurance of long-lasting comfort.

# ERGONOMICS AND PERFORMANCE



### Efficient, safe ultrasound

Designed to safeguard soft tissues, the new SC scalers are ideal for supragingival prophylaxis and more invasive periodontic tasks. They enable excellent operational features even for preparatory procedures of small caries besides in endodontic root canal cleaning procedures.

### Ergonomics and comfort

The excellent size of the instrument with a weight of less than 55 grams, make the SC scalers very comfortable instruments to use even during the longest lasting procedures. The grip is always easy and balanced.

### Technology and control

SC-A2 (without lighting) and SC-A3 (with LED lighting) are controlled by highly advanced electronics, able to regulate the vibration amplitude by way of a retroactive power signal adjustment.



Standard tips: Tartar Scaler

### i-XR3 brushless micromotor

The i-XR3 brushless micromotor is available with or without LED lighting (i-XR3L). Suitable for conservative and prosthetic dentistry, both of which can be cold-disinfected, provide a maximum torque of 3 Ncm and a speed range from 1,000 to 40,000 rpm.

Dimensions: Ø22 x 35,1 mm  
Weight: 82 g



### Silent Power Turbines

Lower hearing stress and less discomfort, in an environment that thus becomes more comfortable for everyone. Thanks to cutting-edge ball bearing technology, high precision rotation and fluid dynamic analysis of air flows, the noise emissions of the turbine have been cut by more than one half, to a medium level of 57 dB(A). The Silver 4LK turbine is preset for the MULTIflex® quick coupling.



### LED lighting technology for the surgical field

A miniaturised circuit with a light-emitting diode replaces traditional halogen bulbs. The emitted white light does not alter the colour of teeth or tissues.



### Multiple irrigation

From two to four spray outlets in the various Silent Power models constantly assure optimal cooling and maximum visibility of the operating field in all working conditions.

Two separate nozzles, one for water and one for air at each point of delivery, prevent the mixture of fluids inside the turbine and reciprocal air and water line contamination.

The flow of coolant is regulated by means of an adjustment ring in the hose connector or quick coupling.

## The versatility of the range

Developed to give dentists every possible opportunity to make the most of their skills, flexibility is a key feature right across the range. Brushless micromotors, powerful yet low-noise turbines and a new generation of ultrasound devices are just a few of the many ergonomic, high performance instruments dentists can choose from.



# LIGHTING AND IMAGING

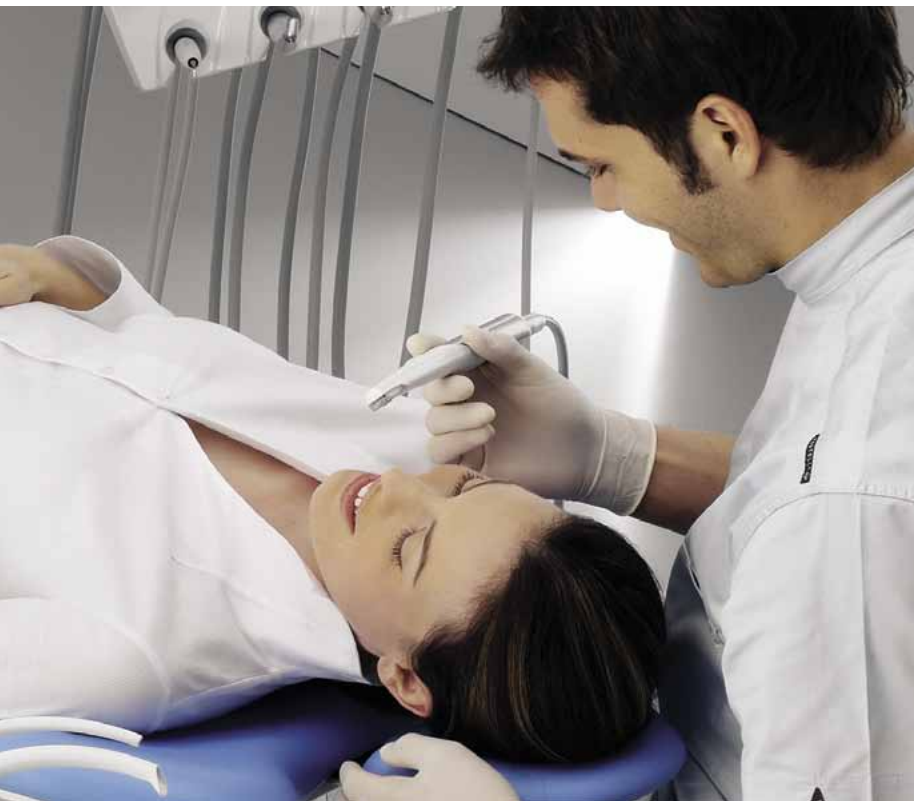

## C-U2

Straightforward and simple to use, totally automatic without the need for any manual adjustments, the C-U2 camera generates clear and explicit images and features the highest degree of illumination in its category.

The control electronics integrated in the dental unit ensures real-time adjustment of all the parameters required for ideal image acquisition: lighted areas and shaded zones, colour brightness, reflection.

C-U2 has a touch-sensitive area through which the freeze-frame function is activated and images are obtained without any vibration-induced blur. The freeze-frame function can also be used via the foot control.

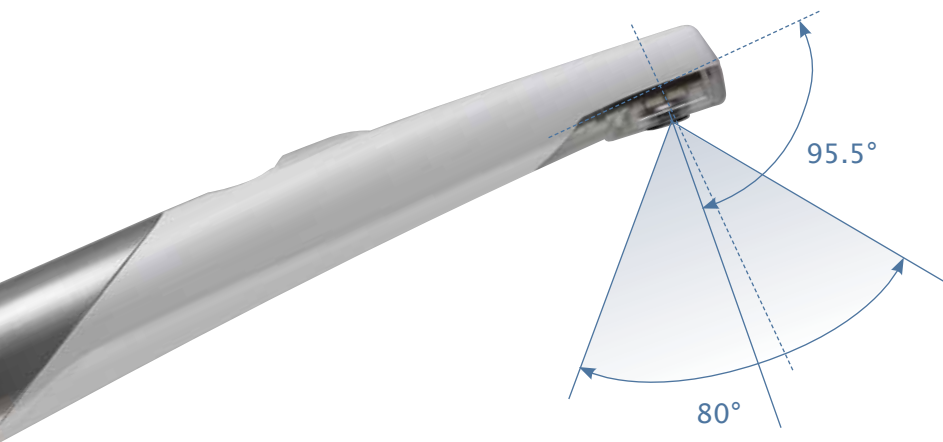

## Retro-Flex Vision

The wide viewing angle is partially inclined away from the extremity of the handpiece in such a way as to enable easy access to distal and posterior tooth areas, just where a traditional 90° angle makes adequate visualisation awkward to obtain.

## C-U2 PRO

The highly sophisticated PRO optics provide uncompromised image quality in three different focal adjustments.

- Macro Close-Up: enhances the perception of the tiniest details.
- Intra-oral Depth of Focus: inspect the entire oral cavity easily thanks to the thin distal end of the camera.
- Extra-oral Vision: grabs a smile to add to patient records.



## VENUS

Versatile and practical, the VENUS light provides optimal illumination of the operating area.

- Colour temperature : 4,900 K
- Light intensity: 8.000/22.500 Lux
- 2-axis rotation
- Built-in cooling



## VENUS PLUS\*

The VENUS PLUS light moves around 3 axes (including the optical unit diagonal), allowing the user to adapt the light to the oral cavity from every angle.

- Colour temperature: 4,900 K
- Light intensity: from 8,000 to 35,000 Lux (adjusted via potentiometer)
- Soft-start device with automatic, progressively increased brightness
- Built-in cooling
- Removable front screen
- Removable handles



## VENUS PLUS – L LED\*

New high performance operating light with dual-reflector LED technology and 3-axis positioning to ensure the lighting axis is always parallel to the dentist's line of sight.

- Colour temperature 5,000 K
- Light intensity from 6,000 to 50,000 Lux
- Low consumption and high lighting efficiency
- LEDs guaranteed to work 50,000 hours



(\*) optional

# Communication made simple

Communication through images is both simple and immediate. Incorporating an imaging system involves the patient in every stage of the treatment process, providing him/her with the necessary motivation to embark on the program of therapy. The simplicity of the devices and the sheer immediacy of communication makes for greater patient awareness and also places emphasis on the importance of dialogue and continuous attention to the patient.

# INTEGRATED X-RAY SYSTEM



### Precision and safety

Designed with outstanding digital X-ray imaging and the patient's health in mind, the constant-potential tube, together with one of the smallest available focal spots (0.4 mm), ensures sharp images every time. The 12" (30 cm) collimator also enhances X-ray beam parallelism to provide sharper, more precise quality images.



### RXDC with HyperSphere technology

The RXDC X-ray unit is equipped with HyperSphere technology.

Rotating freely around the revolutionary spherical coupling, the tube can reach any position, including the vertical.

An automatic touch-sensitive lock/release device allows fast repositioning of the tube between exposures.

### Wireless control

The RXDC is supplied with a portable wireless digital control device. Extremely user-friendly, the control device provides a comprehensive range of exposure programmes, specially designed to make proper X-ray acquisition a direct process.

The RXDC automatically calculates the correct exposure on the basis of the selected anatomic area.



### ZEN-X X-ray sensor

To complete integration of the digital X-ray system the new removable sensor is conveniently located on the dentist's module. The lead mounted at the rear of the sensor reduces its overall size.

Smoothed, rounded design makes correct positioning inside the oral cavity easier. Moreover, thanks to the absence of protruding upper edges, it is also more comfortable in the mouth.

A reinforced lead connector and lining seal protect the sensor perfectly and improve device solidity. Easily sanitised and removed, the sensor and its lead can also be transferred and installed on other machines with compatible connections.

### Size 1: 20x30 mm



### Size 2: 26x34 mm



## Enhanced diagnostic capacity

Fitted directly on the dental unit, without any of the inconveniences associated with a separate installation yet with all the advantages of having an advanced X-ray system within a compact area, the RXDC with HyperSphere technology, together with the ZEN-X sensor and LCD monitor, represent an outstanding direct-diagnosis solution. Shorter times, immediate results, instant effectiveness.



# ALL-ROUND SAFETY



Holder guides provide support during removal and replacement of the suction tubing. The guide can be removed for easier disinfection and cleaning.



The suction inlets can be completely removed for thorough cleaning and sterilisation.



Controls on both dentist's and assistant's module are easily wiped clean and feature disposable covers.



Tanks, internal filters and amalgam separator are easily accessible to make maintenance and cleaning easier.



The soft silicone instrument support mat can also be removed and autoclaved.



Made of stainless steel, the dentist's and assistant's tray holders can be removed and autoclaved.



### Automatic Chip Air

The system automatically emits an air jet when you stop using dynamic instruments so as to clean any residual liquids or solids from the handpiece and so prevent any risk of backflow or patient-to-patient cross-contamination.



### SANASPRAY

SANASPRAY consists of a pressurised 2-litre container that allows distilled water (with added sanitising fluids if required) to be used for all the dentist's module instrument sprays and the assistant's syringe.



System compliant with  
EN 1717 (DVGW)



W.H.E. Water Hygienisation Equipment – Continuous hygiene system with Type A air gap separation from mains water as per EN 1717 standards.

Type A devices ensure there is a 20 mm gap between the mains water and the unit piping in compliance with the most recent mains water backflow contamination prevention standards.

The system also features a mixing tank for titration (0.06%) of water with H<sub>2</sub>O<sub>2</sub> to provide a secure bacteriostatic effect in the unit water circuits.

## Hygiene at all times

The safety of both patient and dental team has always been one of our top priorities and, for this reason, we have created a complete system of both “active” and “passive” hygiene. The S200 features effective solutions and systems to prevent the risk of contamination, providing a safe treatment centre with outstandingly reliable hygiene. The passive hygiene concept, in fact, was developed right at the initial design stage. Daily disinfection tasks are made easier by the numerous parts that can be dismantled and removed.



HYGIENE SYSTEMS	S200 Continental	S200 International
BIOSTER	-	-
A.C.V.S.	-	-
SANASPRAY	★	★
W.H.E.	★	★
I.W.F.C.	-	-

DENTIST'S MODULE		
Micromotor i-XR3 (1,000 – 40,000 rpm)	•	•
Micromotor i-XR3L with f.o. (1,000 – 40,000 rpm)	★	★
3-way syringe	•	•
6-way syringe	★	★
6th instrument	-	★
Module with T-LED curing light	★	★
Module with scaler	★	★
Integrated X-ray sensor module	★	★
X-ray viewer for intraoral films (30x40)	•	•
Panoramic X-ray viewer	-	★

UNIT BODY		
Motor-driven cuspidor bowl	-	-
Ceramic cuspidor bowl body	•	•
Water to cup heater	★	★
Spray heating	★	★
Independent cannulae selection	-	-
Hydraulic saliva suction	★	★
Air/water connections	★	★
Suction stop switch on foot control	•	•
Wired for multimedia applications	★	★
Dentist's side tray holder	•	★
Assistant's tray holder	★	★
VENUS operating light	•	•
VENUS PLUS operating light	★	★
VENUS PLUS – L LED operating light	★	★

PATIENT CHAIR		
Atlaxis 3 headrest	★	★
Mobile, removable right armrest	★	★
Left armrest	•	•
Memory Foam padding	★	★
Child's cushion	★	★
Standard foot control	•	•
Standard foot control with joystick for chair movement	★	★
Pressure-operated foot control with joystick for chair movement	★	★
Power Pedal foot control with joystick for chair movement	★	★

## S200 CONTINENTAL

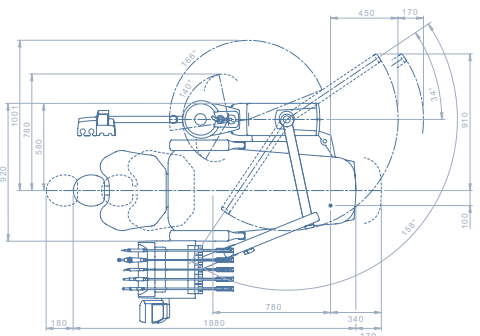
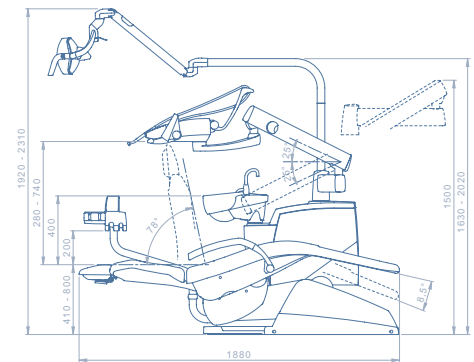

## S200 INTERNATIONAL

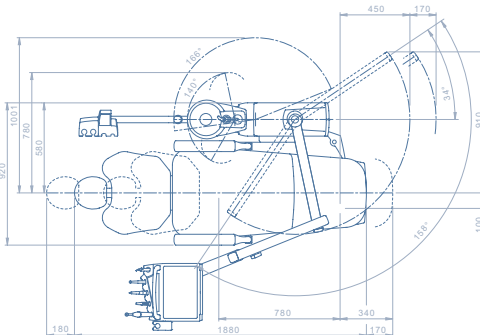
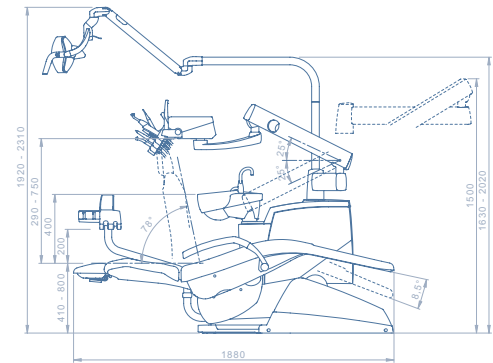

## S200 SHORT ARM

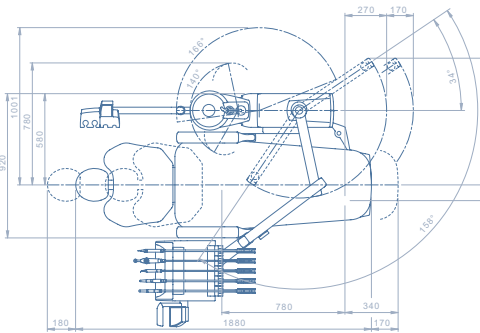
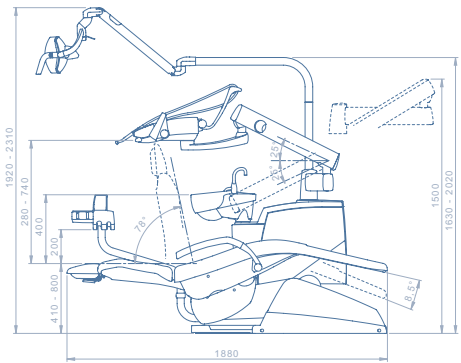

Dimensions are quoted in millimetres.

• as standard      ★ optional      - not available

